

Allied Cooperative's Customer Portal – “POCKT”

Instructions for Microsoft Edge

1 - Go to www.allied.coop

2 - Click on Customer Login on the top menu bar. Then click Account Login/Make Payment.

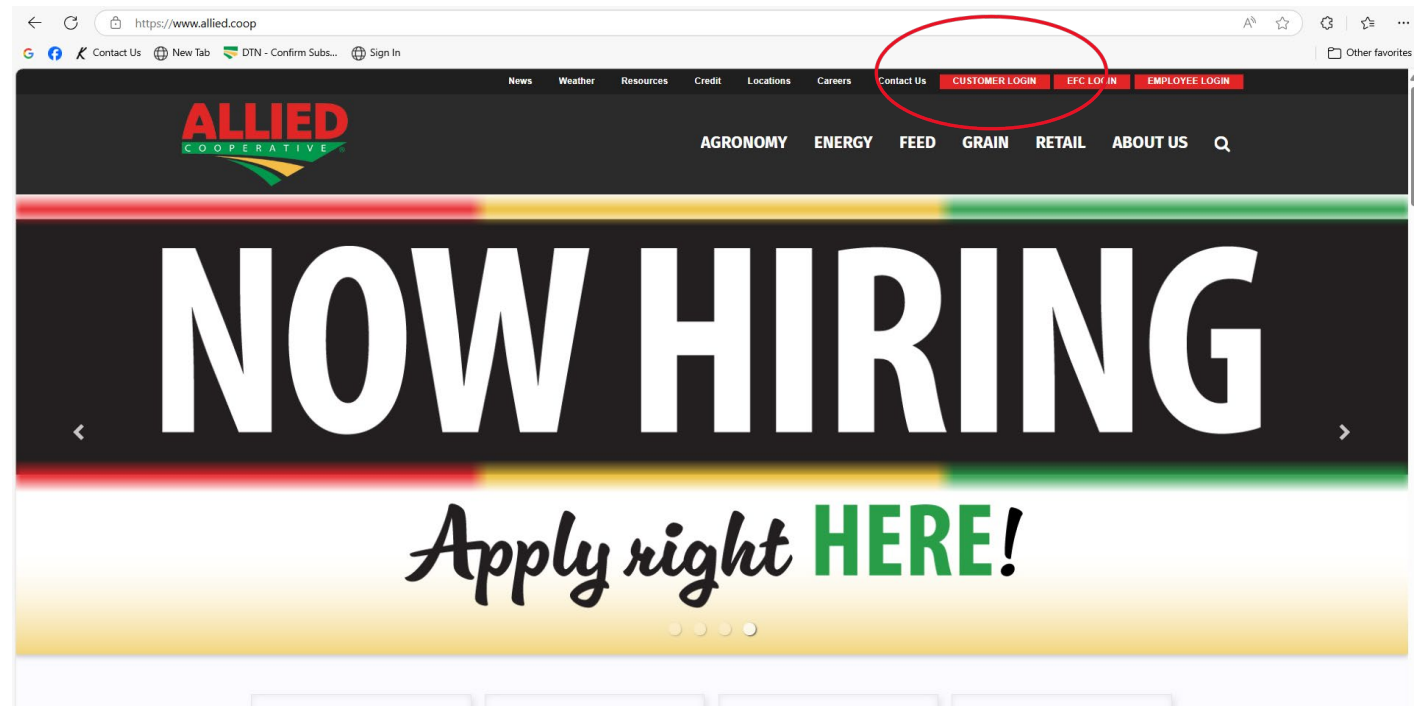

3 – Click on the Install shortcut icon at the right side of search bar to install the app/shortcut on your desktop. Select desired preferences and click Allow.

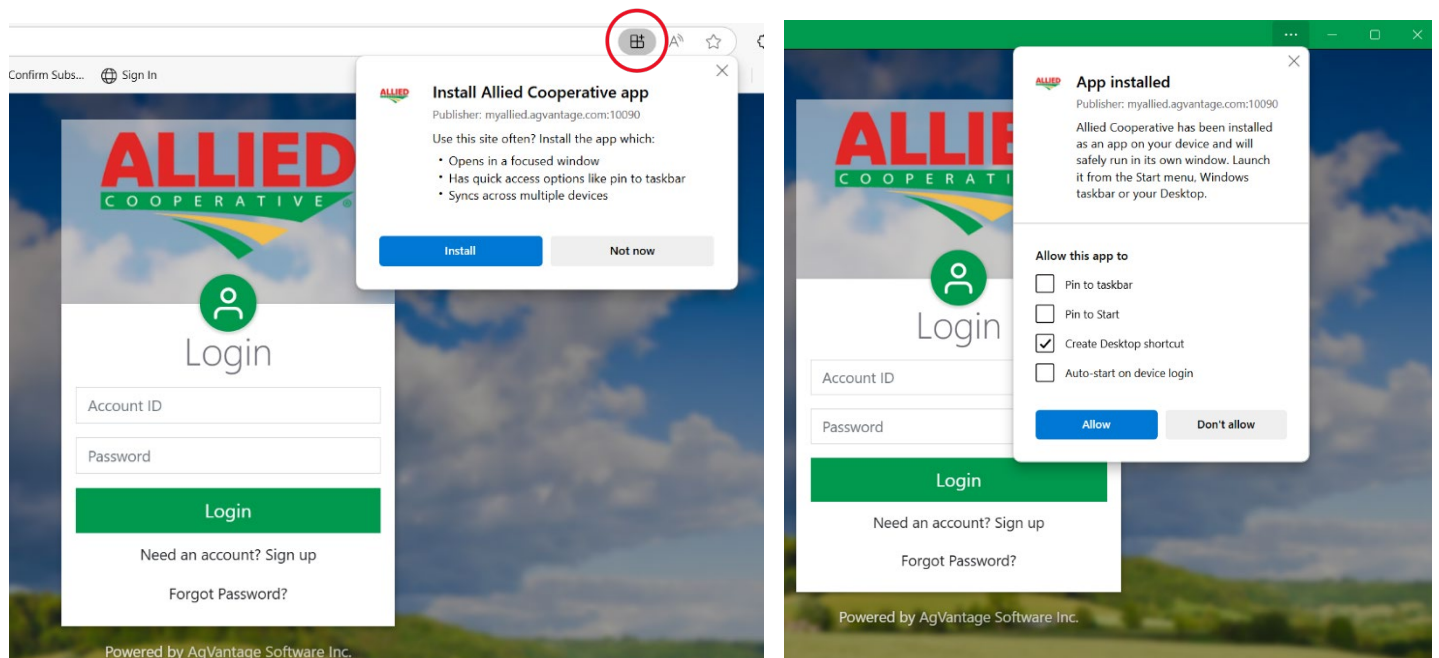

4 – Enter your account ID and password and click Login.

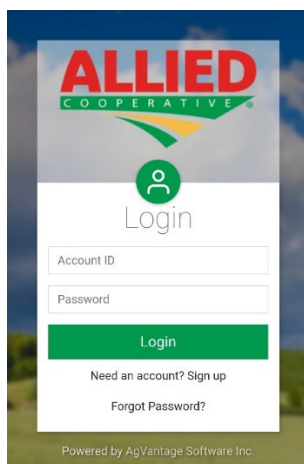

5 – If you want to have your account information remembered on your device, click Setup Local Account, then setup a PIN. You will also have the option to set-up biometrics for your account on the next screen. Otherwise Skip.

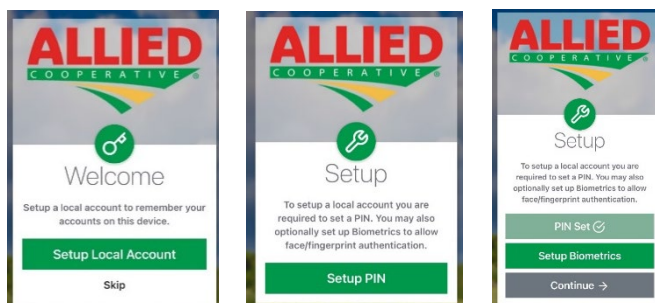

6 – If you have multiple accounts that you wish to access with one login, you may add them during this step. Otherwise select your name/account # to access your account information.

Please note: If you need access to multiple accounts you will need to “Sign-up” for access for each of these accounts. Then you may add the account to your device/computer login screen.

